



### Notice Inviting Quotations (NIQ)

National Institute of Design (NID) invites quotations from the reputed and experienced agencies / vendors for "Supply and installation of aluminium fixed glass partition as per enclosed drawing, scheduled, terms & conditions"

The quotations shall be received in the Office of the Chief Administrative Officer, NID, Paldi, Ahmedabad.

The last date of submission of quotations: upto 4.00 pm on upto 22.11.2023.

Name of Work :	Supply and Installation of aluminium fixed glass partition at NID Ahmedabad campus.
Date & Time of opening of quotations :	22.11.2023 at 5.30 pm at NID Paldi, Ahmedabad

#### Terms & conditions:

1. The bidder, who are having work experience of doing similar aluminium work of at least Rs 4 (four) lacs during past 5 (five) years are eligible for participation in this tender. Work experience of Govt work shall be desirable though not essential. Purchase order / work order and Experience certificates of works done should be attached with submitted quotations.
2. The bidder is advised to visit the site before submitting the quotation at his own cost, and examine it and its surroundings to collect all information that he consider necessary for proper execution of the work.
3. Work completion time period shall be 15 days from the date of issue of work order.
4. The rates shall be inclusive of all applicable taxes. If the tax, is not quoted separately the quoted amount will be considered inclusive of all taxes, duties, other charges etc. The decision of NID shall be final in this regard.
5. The rates shall be inclusive of material, labour, to & fro transportation & for a work upto 2nd floor of building at NID Campus Ahmedabad. Validity of rates shall be up to 12 months from the date of opening of quotation.
6. In case of any mishap / incident relates to the work in quotation the liability will be borne by the contractor only, NID will not be responsible for any misshaping in this regard.
7. The bidder shall be required to submit along in the Technical Bid envelope, the Earnest Money Deposit (EMD) of Rs. 19,000/- (Rupees Nineteen thousand) by Demand Draft / Banker's Cheque / Pay Order drawn on a Nationalized / Scheduled Bank payable at Ahmedabad in favour of the "National Institute of Design".
8. Performance Security: 5% of total contract value (including EMD) including taxes is to be submitted after issue of work order in the name of National Institute of Design payable at Ahmedabad in the form of DD/ PO from Nationalized / Scheduled bank. It will be released without any interest after 90 days of defect liability period.
9. The payment shall be released against submission of invoice duly checked, verified and certified for payment by internal technical team, Executive Engineer and HOD of NID.

10. Retention amount: 10% of total contract value will be deducted from the running bill / final bill amount and It will be release without any interest after 90 days defect liability period.
11. NID reserves the right to increase/decrease the quantities upto 30% as per requirement of NID till placement of work order.
12. NID reserves the right to place an additional repeat order for upto 80% quantity of items covered in this NIQ with same rates, terms and conditions within one year from date of work order.
13. NID reserves the right to reject any or all the Quotations, in part or full, without assigning reason thereof. Part, conditional offers are not acceptable.
14. Work shall be awarded to technically qualified (as per SI no 1 above) and lowest price bidder.
15. Please submit your offer in a sealed cover, addressed to the Chief Administrative Officer, National Institute of Design, Paldi Ahmedabad 380 007 latest by 4:00 pm on 22.11.2023.

Chief Administrative Officer  
NID

Copy to: NID Website [www.nid.edu](http://www.nid.edu)

## Schedule of Quantity

**Name of work:** Supply and Installation of aluminium fixed glass partition with all required fittings / accessories etc.

**NIQ No.** NID/NIQ/09/23-24

**NID Ahmedabad Campus**

Item No.	Description of Item	Qty.	Unit	Rate (Rs.)	Amount (Rs.)
1	Supply and installation of fixed glass partition window using Jindal make "Cardinal – 50 Euro" series (Section 1105, 1103, 1060, 1059, 1062, 1065) including all required fittings.	150	Smt		
2	Supply and installation of 6mm thick compact sheet with all required fittings.	60	Smt		
3	Supply and installation of 6mm thick toughened glass with all required fittings.	75	Smt		
		Total Amount (Rs.)			
		Applicable taxes ____%			
		Total amount including taxes ( Rs )			

Total amount in words \_\_\_\_\_

Signature and Stamp

## Technical Specification

1. Aluminum section to be used : Jindal make “Cardinal – 50 Euro series”  
Section 1105,1103,1060,1059,1062,1065
2. Coating : Powder coating Akzonoble / Jotun 25 years warranty. 60 – 70 Micron  
Shade : Brown (selected)
3. Gasket : EPDM Gasket considered AIGIRI / OSAKA / MPP make with 10 years warranty.
4. Glass : Saint Gobin / HNG make considered, 6mm thick clear toughened
5. Compact Sheet : 6mm thick, ISI or equivalent make approved by NID, shade : Off white
6. Final measurement shall be as per actual surface area at site.
7. A 10% retention money will be deducted from final bill submitted by the contractor and will be refunded without any interest after 90 days from the date of completion of work.

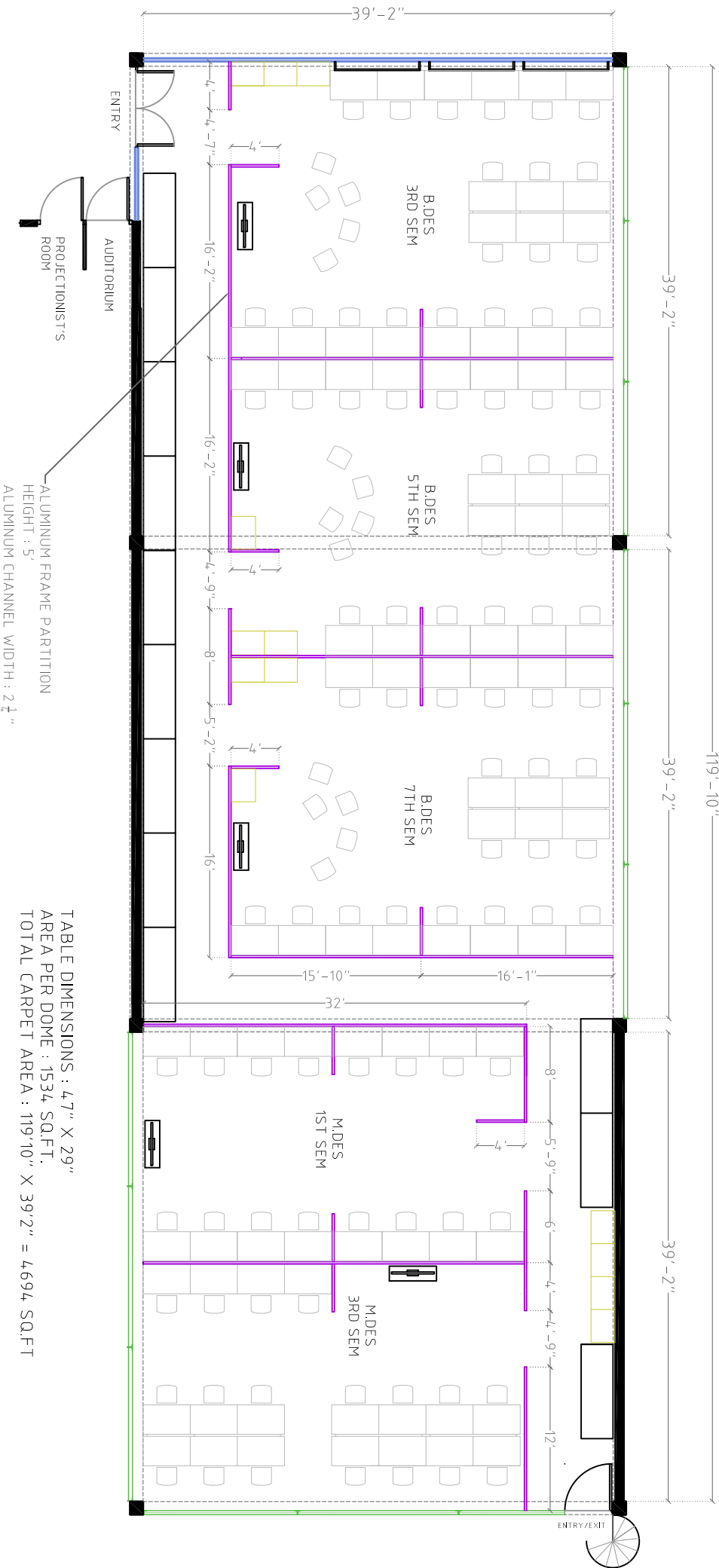

TABLE DIMENSIONS : 47" X 29"  
 AREA PER DOME : 1534 SQ.FT.  
 TOTAL CARPET AREA : 119'-10" X 39'-2" = 4694 SQ.FT

